

BARRINGTON HORIZONTAL

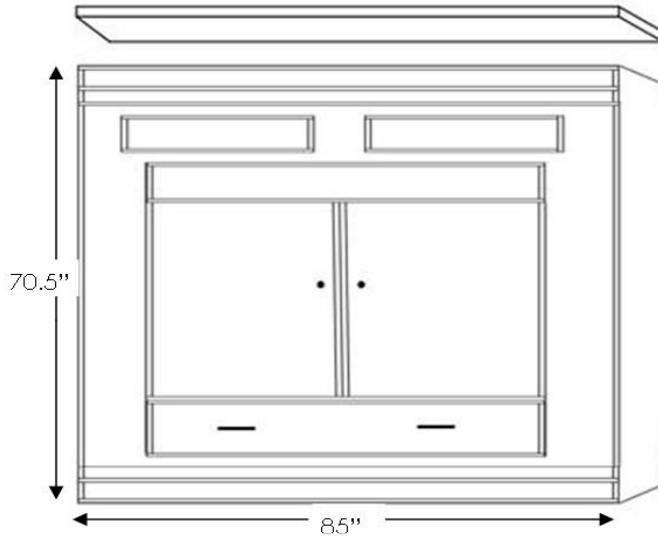

STAIN FINISH





BARK GRAY (BG)	CARAMEL (B)	MAPLE (M)
NATURAL (N)	SUNSET (S)	COGNAC (R)
ESPRESSO (D)	CINNAMON (E)	GRAY (G)

PAINT FINISH * +10% UPCHARGE

*WHITE (WH)	*ALABASTER (A)	*COBALT (C)

SKU	DESCRIPTION	CLOSED DIMENSION	OPEN DIMENSION	MATTRESS DEPTH
BS50	QUEEN HORIZONTAL	85w x 17d x 70.5 h	85w x 66d x 70.5 h	12"
BSTOP	FINISHED TOP			



<p>3 DRAWER</p> <p>BTHQS 16 X 70.5</p> <p>BTHQM 24 X 70.5</p> 	<p>2 DRAWER NIGHTSTAND</p> <p>2 Drawers - pull out tray with ~ open adjustable shelves.</p> <p>BNHQS 16 X 70.5</p> <p>BNHQM 24 X 70.5</p> 	<p>2 LATERAL FILES-PENCIL</p> <p>2 Lateral File Drawers, pencil drawer with adj. shelves</p> <p>BLHQS 16 X 70.5</p> <p>BLHQM 24 X 70.5</p> 	<p>BOOKCASE</p> <p>BBHQS 16 X 70.5</p> <p>BBHQM 24 X 70.5</p> 
---	--	---	--

2 DOOR

BSHQL 32 X 85

BSDL Shaped Desktop

BLD DESK BASE

DOOR

BDHQS 16 X 70.5

BDHQM 24 X 70.5

BSD Straight desktop

BFD DESK BASE

DESK-DC 63w X 31 1/2h x 22d

FILE CART BFC 16 5/8x 28 1/2 x 22

NIGHTSTAND

NIGHTSTAND-3 DRAWER-BNS 24w x 16d x 29h

NIGHTSTAND-2 DRW TRAY-BNST 24w x 16d x 29h

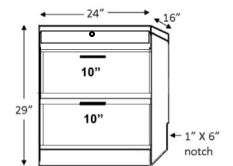

TOP FLUSH ON SIDES AND BACK